

Team Emergence Analysis & Measurement Simulation System (TEAM Sim)

Primary Simulation Management & Control Cluster

- Experimental Control
 - 1 Dell Workstation (dual display)
 - Switch, USB server, keyboard, display (entity control)
 - Remote projector (instructions, training)
 - Audio (speaker array)
 - Printer, scanner (experimental materials)
 - Wireless router
- 2 Dell Workstations (Development & testing)

Data Analysis & Visualization Suite

- Sony VAIO Z*
- SPSS (Data Analytics)*
- M-Plus (Multilevel Modeling)
- Lexcimancer (Latent Semantic Analysis)
- Pathfinder (Network Analysis)
- Dell display cluster
- 60" Samsung 1080p display
- Lenovo X220
- Computational modeling control (HPCC)

Department of Psychology Server Cluster

- Web server*
- Data server & data base repository*
- Dell Power Vault TL4000 Tape storage & back-up; media

Primary Team Experimentation Cluster

- 18 Dell Workstations (6 human teams of 3 members each)
- 12 Dell Workstations ("Synthetic" teammates/autonomous entities)
 - The system is capable of running a mix of human-agent teams:
 - 3 human, 2 humans/1 agent, 1 human/2 agents
- Misc (Headsets, HDDs, cables, mouse pads, etc)

Remote / Satellite Experimentation Cluster

- 9 Dell Workstations (3 human teams of 3 members each)
 - The system can interface with the Primary Cluster (human and/or agent); Thus, virtual human/agent teams can be created
- 1 Dell Workstation (Experimental / local control)
- 1 Dell Workstation (Development & testing)

Mobile Experimentation Cluster

- 3 Asus G75VW RS72 (1 human team of 3 members each)
- 1 Asus G75VW DS71 (experimental / local control)

MSU High Performance Computing Center (HPCC)*

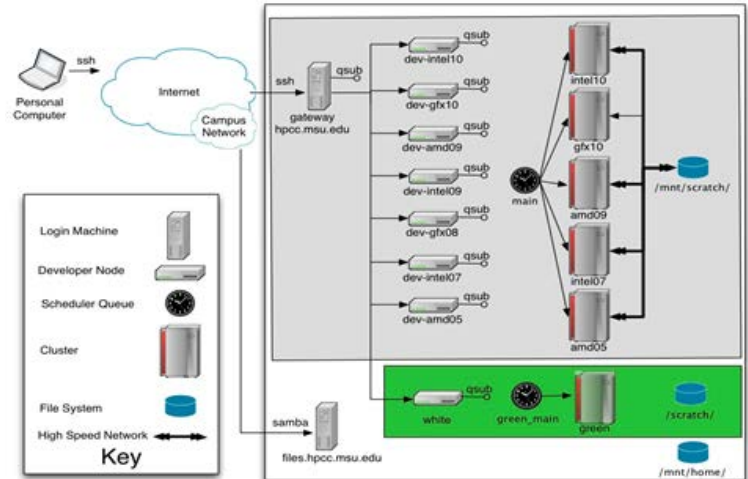

*Pre-existing

The TEAM Sim System is composed of one primary and a comparable secondary lab for running simulation experiments using human teams. The labs complement our computational modeling work that utilizes agent-based simulation to conduct “virtual experiments.”

